

## Basic Line SL 12W

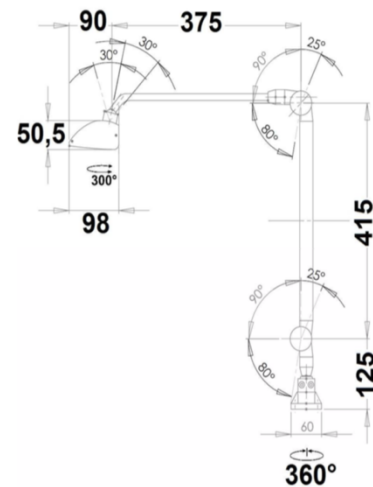

### Technical data

<b>Light distribution</b>	wide - symmetric high-lustre anodized reflectors, direct lighting
<b>Control gear</b>	electronic LED-driver, no dimming
<b>Mains lead</b>	approx. 2m cable H03VV-F3G0,75 with Schuko-plug, 220-240V~/50-60Hz
<b>LED-cover</b>	microprism screen + bi-functional diffusor foil (turnable for 2 different degrees of diffusion)
<b>Switch</b>	switch in joint arm (ON/OFF)
<b>Power</b>	LED-power approx. 11,3W, system power approx. 14W
<b>LED-lifetime</b>	up to 60.000 hrs.
<b>Protection class</b>	IP20
<b>Joint arm</b>	ball joint, freely positionable
<b>Weight</b>	approx. 2,8 kg

### Profile

- Well-shaped, flat lighting body made of extruded aluminum profile with laser-cut end caps.
- Ball joint, freely positionable sleek reflector head
- Dimensions: Light head **355 x 98 x 50** mm, upper arm **375mm**, lower arm **415mm**
- Colour: silver-gray painting RAL 9006

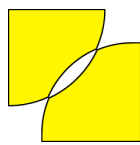

## Light properties

### Leuchteigenschaften

Illuminance at the working area:

Measuring distance	Lux
40cm	up to 3800
50cm	up to 2550

- Bright large-area illumination
- 22 highly efficient HiPower-LED's, **5000K**
- High colour rendition - **CRI > 80 (typ. 84)**
- Integral state-of-the-art LED-driver - no disturbing separate power supply.
- Good glare protection provided by microprismatic screens plus additional diffusor foils.
- 

## Mounting brackets

- Picture 1: screwdown flange 60 x 60 mm **(incl.)**
- Picture 2: table clamps with a span of 0-44mm or 15-85mm
- Picture 3: table base 10,5kg, 240 x 265mm



Picture 1



Picture 2

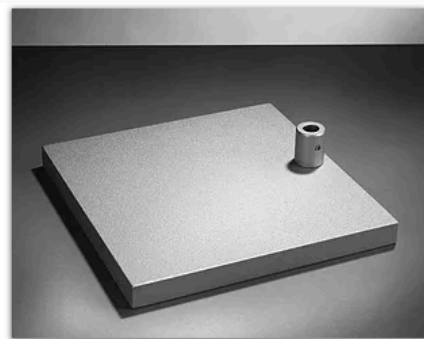

Picture 3